



## WON-23 4-waste recycling island



This is a metal element consisting of a square-shaped central totem attached to a base that allows the four waste bins to be placed in order, one on each side of the vertical square and secured to the base.

The central totem is made of 1 mm thick steel plate. It is quadrangular in shape and incorporates a different pictogram on each of its sides, to be determined by the project manager, which specifies the type of residue to be collected in the waste bin located underneath it.



The base is made of 1.5 mm thick plates arranged in the shape of a cross, the central part of which can be attached to the vertical totem pole. The ends of the cross will also act as a centring device for the waste bins, which will be located tangentially to the face of the totem that has been identified with the residue to be collected and, for better identification by the user, will coincide with the colour of the waste bin head.

Highly resistant architectural paint finish, textured anthracite colour. With interior ballast for greater stability.



**Size:** 1340 x 1340 x 1315 mm.

**Maintenance:** No functional maintenance required. Cleaning recommended with a neutral product and a wet rag.

**Fire resistance:** Due to the characteristics of its all-metal materials, the container can be classified as V0.



## WON-23 4-waste recycling island

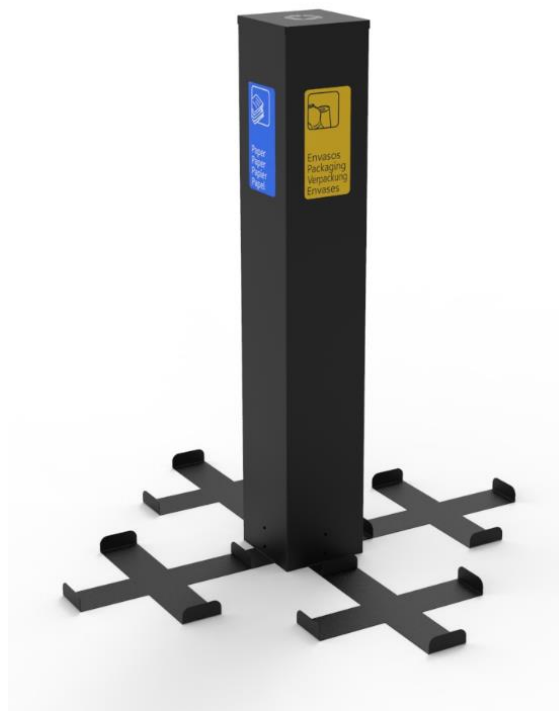



## WON-23 4-waste recycling island

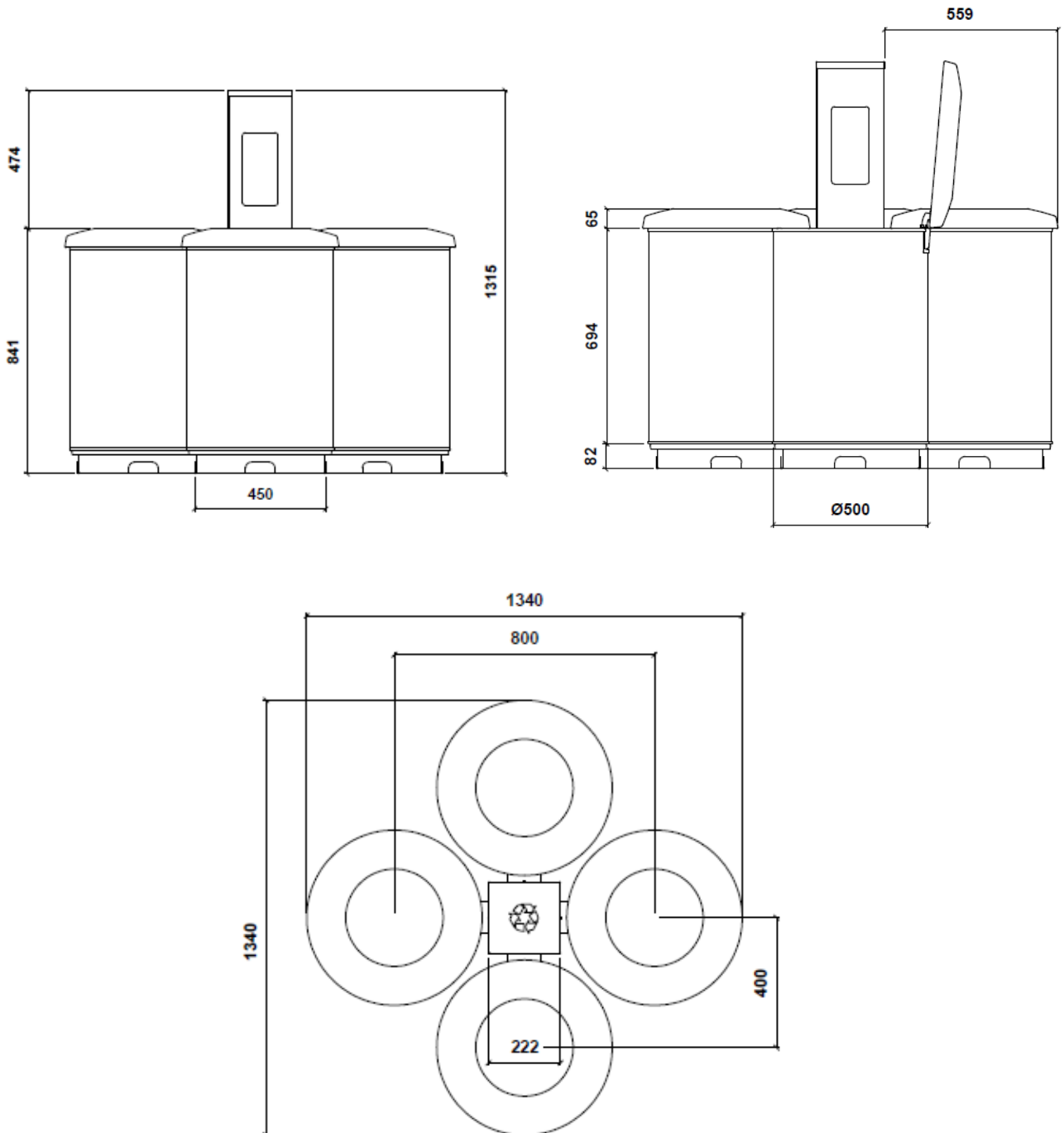



Pol. Ind. Les Guixeres  
Plàstic, 14  
08915 - Badalona  
T +34 933 950 905



[www.unnom.es](http://www.unnom.es)